

# 5-Drawer Short Emergency Cart (USRLU-33339-RED)

 [waterloohealthcare.com/product/5-drawer-short-emergency-cart](https://waterloohealthcare.com/product/5-drawer-short-emergency-cart)





Waterloo made its name in emergency carts back in the 1950s, and is still the most recognized name in emergency carts today. Our traditional steel carts are an economical option that will last for decades to come.

#### KEY FEATURES:

- Economical steel construction
- Single pull out work shelf
- Transport lock keeps drawers secured during rapid transit

SKU: USRLU-33339-RED Category: [Emergency Crash Carts](#) Tag: [Emergency Cart](#)  
[Aluminum](#)

## SPECIFICATIONS

---

Frame Type: STEEL STANDARD  
 Frame Size: SHORT  
 Dimensions: 29"w x 24.5"d x 36"h

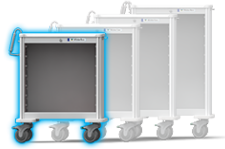

Drawer Dimensions: 22"w x 16.5"d

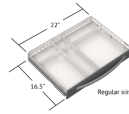

Drawer Height: 3-3-3-9



4 drawers

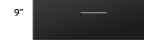
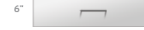

1 drawer

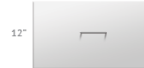

Frame Color: RED

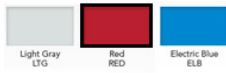

Drawer Color: RED



Lock System: LEVER LOCK

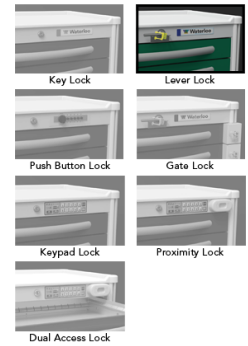

Top: REMOVABLE PLASTIC



Bumpers: STABILIZER BASE

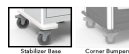

Casters: 5" STANDARD

