

5-Drawer Tall Anesthesia Cart (UTGKU-33669-DKB)

 waterloohealthcare.com/product/5-drawer-tall-utgku-33669-dkb



Waterloo anesthesia carts have been widely used in the OR for decades. With a variety of organizing accessories and drawer trays, anesthesiologists have critical supplies at their fingertips.

KEY FEATURES:

Variety of locking options available including dual-credential/auto-relocking controlled substance drawer

Single pull out shelf

Economical steel construction

SKU: UTGKU-33669-DKB Category: Anesthesia Carts: The Best Carts for Your Medical Facility

SPECIFICATIONS

Frame Type: STEEL STANDARD
 Frame Size: TALL
 Dimensions: 29"w x 24.5"d x 42"h



Drawer Dimensions: 22"w x 16.5"d

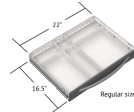

Drawer Height: 3-3-6-6-9

3"  2 drawers

6"  2 drawers

9"  1 drawer

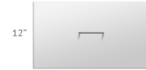

Frame Color: LIGHT GRAY



Drawer Color: Dark Blue



Lock System: KEY LOCK

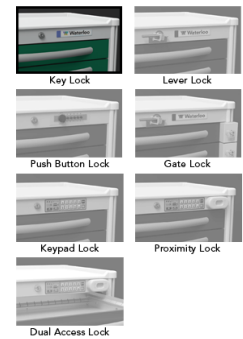

Top: REMOVABLE PLASTIC

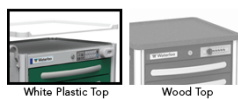

Bumpers: STABILIZER BASE

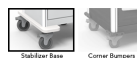

Casters: 5" STANDARD

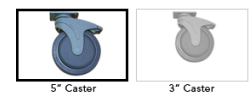

Compare Security Locking Systems

GETTING THE RIGHT ACCESS METHOD	Key Lock	Levers Lock	Mechanical Push Button	Electronic Keypad	WiFi Enabled Keypad	WiFi Enabled Keypad with Cardholder Substance Detector
	\$	\$	\$	\$5	\$55	\$225
Standard Key Access	●					
Tamper Evidence		●				
Individual Drawer Locking with Key or Breakaway Seal	●	●	●	●	●	●
Keyless		●	●	●	●	●
Automatic Relocking				●	●	●
Proximity/Employee Badge Access				●	●	●
Ability to Track Lock/Unlock Events				●	●	●
Ability to Control User Access to Specific Times During the Day				●	●	●
Updates to Lock Performed MANUALLY by use of laptop				●		
Updates to Lock Performed AUTOMATICALLY via WiFi					●	●
Maximum Unique User Count				250	3000	3000
Requires LockManager Software				●	●	●

● Standard Feature ● Optional Feature

[Click Here to Learn More About Our Locking Systems >>](#)